

## 88MM MULTIMEDIA SPEAKER



Paper cone with metal frame -

Full range speaker (90~15kHz)-

Suitable for different acoustics devices -

Dual magnet design to boost the performance -

With magnetic shield -

### Key Specification

8Ω 10W

Dual NdFeB magnet

Paper cone

### Dimensions

Ø 87 x 55 mm

### Net Weight

340g

\* above photo is for reference only

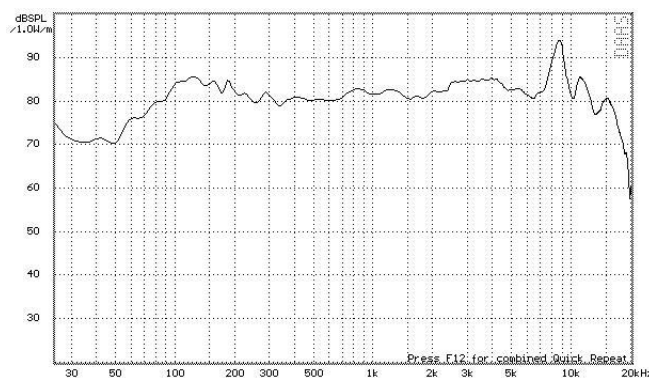

### SPECIFICATIONS

Outer Size	Ø 87mm
Maximum Height	45mm
V.C. Size	Ø 20.4mm
Impedance	8Ω
Resonant Frequency	90Hz
Frequency Response	Fo - 15kHz
Output S.P.L.	81dB
Input Power	10W / Max 12W
Cone Type	Paper
Net Weight	340.4g

### MAGNET

Materials:	NdFeB
Size:	Ø 55 x 25 x 10 mm + Ø 50 x 22 x 6 mm

### TEST CONDITION

Operation Test	6V Sine Wave
Buzzes & Rattles	6V Sine Wave Peak
Heat Test	55±2°C 48hrs
Cold Test	-25±2°C 48hrs
Humidity Test	40±2°C R.H.90-95% 48hrs
Load Test	Pink Noise 10W 48hrs
Distortion	5% Max

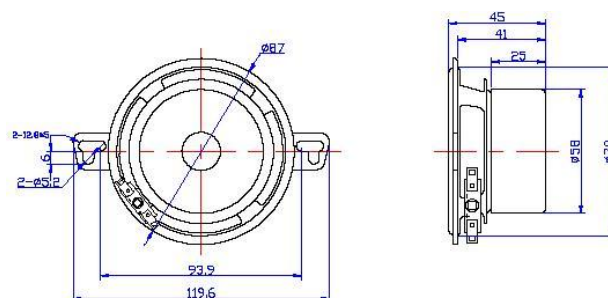

WING CHEONG ELECTRICAL CO., LTD.

Room 1314, Block A, Hoi Luen Ind. Ctr.  
55 Hoi Yuen Road, Kwun Tong,  
Kowloon, Hong Kong  
Tel: (852) 3465 7633 Fax: (852) 2385 6988  
Website: www.wingcheong.com  
Email: sales@wingcheong.com

© 2014 Wing Cheong Electrical Company Limited. All rights reserved. All specifications and other information shown were current as of document revision and are subject to change without notice.